

D

C

B

A

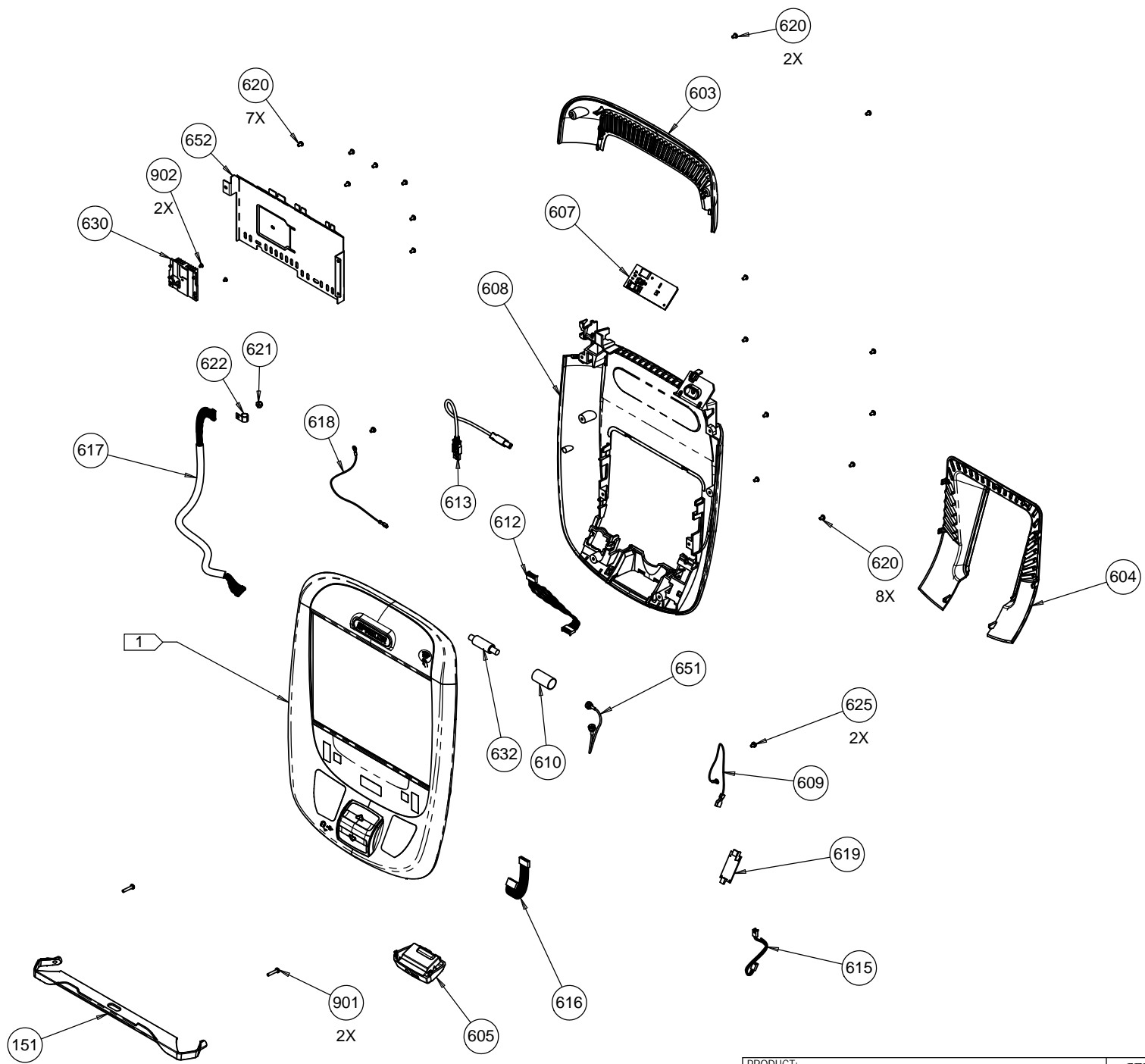

NOTES:
 1 THIS IS A COMPLETE DISPLAY ASSEMBLY, PACKAGED FOR SHIPPING.

PRODUCT: P82 CONSOLE					
DRWN BY	12/22/15	SAH	SIZE		
CS			A	1 OF 1	
				DWG. NO.	SUBREV
				304096-101	A

DRAWING TEMPLATE REV. C

SAP Material #	Item Description	Bubble Numbers
PPP000000302038101	PLUNGER, POWER RESET	67
PPP000000303260103	PLASTIC,RACK,READING/DEVICE, BLACK, P82	151
PPP000000303348112	ASSY,TUNER MODULE, EXETER2 NORTH AMERICA,P82	602
PPP000000300303104	PLASTIC,ACCESS PANEL,UPPER,DISPLAY,TWILIGHT	603
PPP000000303264106	ASSY,BEZEL,LOWER VENT,DISPLAY,P82,W/ PRINT	604
PPP000000303360103	ASSY,HP AND USB JACK,P82	605
PPP000000303750101	MODULE, NFC, P82	607
PPP000000303263104	ASSEMBLY, PLASTIC, REAR, DISPLAY, P82	608
PPP000000040151008	ASSY,CBL,8C,1 CTR,1-1,4 TW PR,W/RAMP & RIBS,SN,8"	612
PPP000000012478012	ASSY,CBL,USB 2.0, A MALE/B MALE,BLACK,12"	613
PPP000000040152007	ASSY,CBL,3C,.1 CTR,W/RAMP & RIBS,1-1,SN,7"	615
PPP000000040011004	ASSY,CBL,8C,.1 CTR,1-1,SN,4"	616
PPP000000303747020	ASSY,CBL,20P20C USB, TWISTED PAIR,HEATSHRINK,20"	617
PPP000000040010008	ASSY,CBL,1C,20AWG,#8 RING/.110X032 QD RECP,BLACK,(8")	618
PPP000000300812101	BOARD,CHR & WIRELESS,SALUTRON,(PORTRAIT),100R	619
PPP00000MGCN016025	SCREW,PAN HD PHIL,8-32 X .25,STL,CLR ZN	620
PPP00000KECN019014	NUT,LOCK,FULL,10-32,NYLON INSERT,STL,CLR ZN	621
PPP000000012865003	CABLE P-CLIP,OPEN ENDED,0.375" BUNDLE	622
PPP00000KLCN019012	NUT,LOCK,10-32,KEPS,STAR WASHER,SSTL,CLR ZN	623
PPP000000012297024	TAPE,3M VHB 4956,0,062"TH ,0.375"W,GRAY	626
PPP000000303270102	BRACKET,SERVICE,P82	652
PPP00000MGCN011025	SCREW,PAN HD PHIL,4-40 X .25,STL,CLR ZN	902